

REV	Description	Date	Appr.
A	Initial Release	4/10/09	BJ

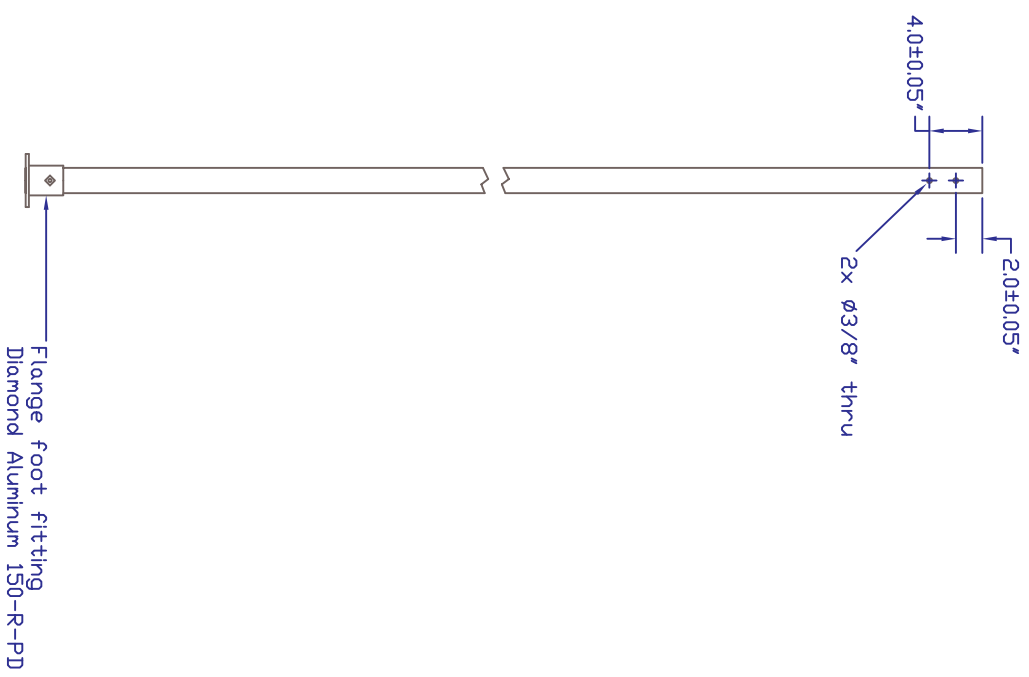

- Notes:
1. Pipe is 1.5' sch 40 6000 series structural aluminum
  2. Overall length is site-specific

<b>Polar Permanent GPS Station Low-Speed Wind Turbine Mast</b>		<b>Part Number</b> PPS-TF-007	<b>Rev</b> A
<b>UNAVCO, Inc.</b> POLAR SERVICES 6350 Nautilus Dr., Boulder CO 80301 303-381-7500, 303-381-7451 fax		Drawing: <b>S. White</b> Engineering: <b>S. White</b> Approval: <b>B. Johns</b> Date Modified: <b>April 10 2009</b>	SHEET <b>1</b> OF <b>1</b>

